

# Parcels owned by Sierra Northern Railway, Mendocino Railway, and Georgia-Pacific in & near Ft Bragg - September 18, 2023 - Steve Scalmanini

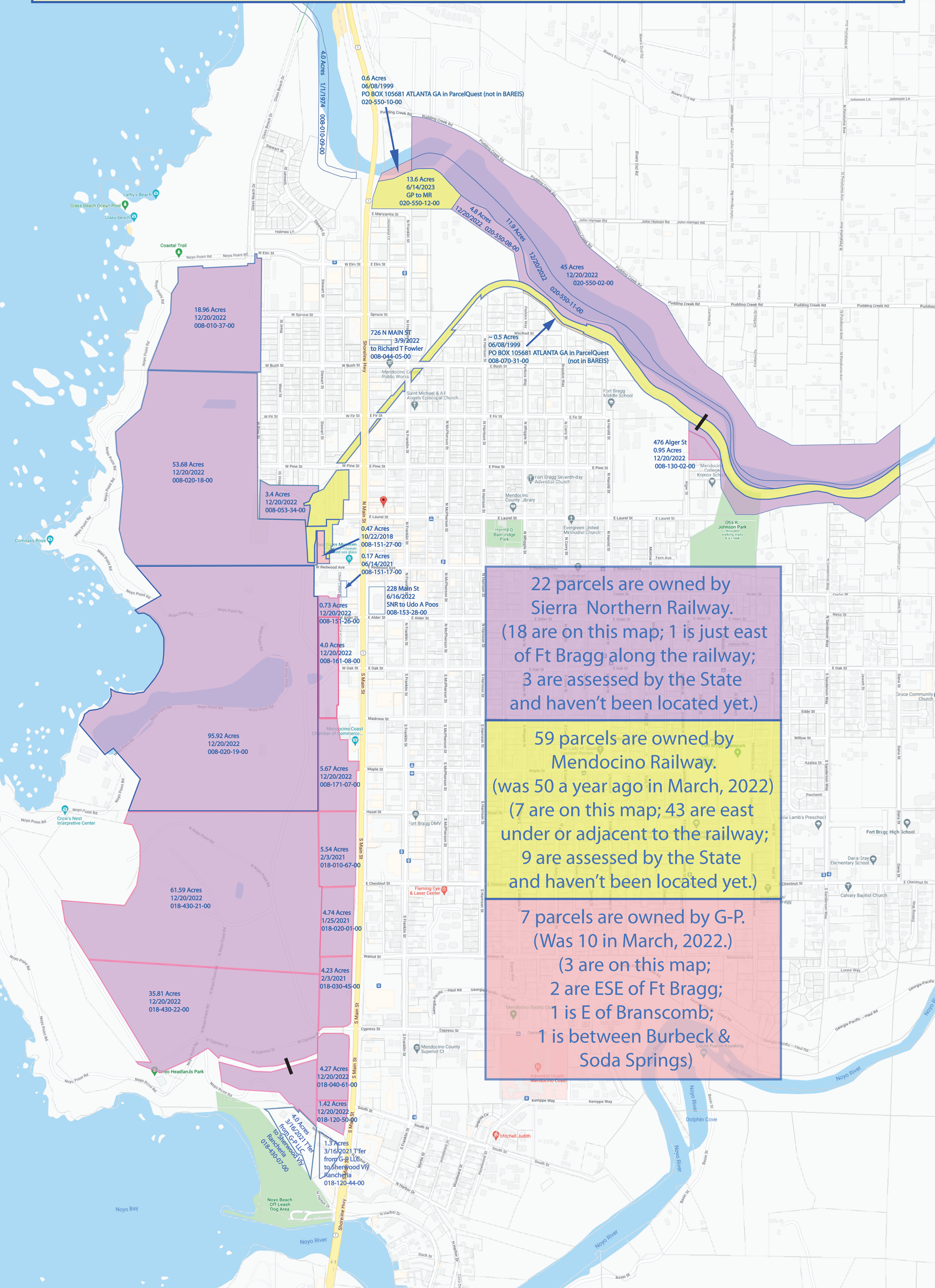

**22 parcels are owned by Sierra Northern Railway.**  
 (18 are on this map; 1 is just east of Ft Bragg along the railway; 3 are assessed by the State and haven't been located yet.)

**59 parcels are owned by Mendocino Railway.**  
 (was 50 a year ago in March, 2022)  
 (7 are on this map; 43 are east under or adjacent to the railway; 9 are assessed by the State and haven't been located yet.)

**7 parcels are owned by G-P.**  
 (Was 10 in March, 2022.)  
 (3 are on this map; 2 are ESE of Ft Bragg; 1 is E of Branscomb; 1 is between Burbeck & Soda Springs)

0.6 Acres  
 06/08/1999  
 PO BOX 105681 ATLANTA GA in ParcelQuest (not in BAREIS)  
 020-550-10-00

13.6 Acres  
 6/14/2023  
 GP to MR  
 020-550-12-00

4.8 Acres  
 12/20/2022  
 020-550-08-00

11.9 Acres  
 12/20/2022  
 020-550-11-00

45 Acres  
 12/20/2022  
 020-550-02-00

18.96 Acres  
 12/20/2022  
 008-010-37-00

53.68 Acres  
 12/20/2022  
 008-020-18-00

3.4 Acres  
 12/20/2022  
 008-053-34-00

726 N MAIN ST  
 3/9/2022  
 to Richard T Fowler  
 008-044-05-00

0.5 Acres  
 06/08/1999  
 PO BOX 105681 ATLANTA GA in ParcelQuest (not in BAREIS)  
 008-070-31-00

476 Alger St  
 0.95 Acres  
 12/20/2022  
 008-130-02-00

0.47 Acres  
 10/22/2018  
 008-151-27-00

0.17 Acres  
 06/14/2021  
 008-151-17-00

0.73 Acres  
 12/20/2022  
 008-151-26-00

228 Main St  
 6/16/2022  
 SNR to Udo A Poos  
 008-153-28-00

4.0 Acres  
 12/20/2022  
 008-161-08-00

5.67 Acres  
 12/20/2022  
 008-171-07-00

5.54 Acres  
 2/3/2021  
 018-010-67-00

61.59 Acres  
 12/20/2022  
 018-430-21-00

4.74 Acres  
 1/25/2021  
 018-020-01-00

4.23 Acres  
 2/3/2021  
 018-030-45-00

35.81 Acres  
 12/20/2022  
 018-430-22-00

4.27 Acres  
 12/20/2022  
 018-040-61-00

1.42 Acres  
 12/20/2022  
 018-120-50-00

4.0 Acres  
 3/16/2021  
 to Sierra Nevada  
 018-430-07-00

1.3 Acres  
 3/16/2021  
 Transfer from G.P. LLC to Sherwood Vly Rancheria  
 018-120-44-00